

4th Edition September 2013

Getting Around

JOHAN JAY

COLLEGE
OF
CRIMINAL
JUSTICE



New Building



Haaren Hall



North Hall



Westport



BMW

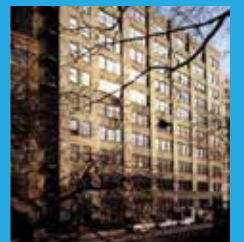

54th St. Annex

CONTENTS

Message from the President	3
The Campus Plan with Department Locations	4
Building Hours & Operational Information	6
New Building with Haaren Hall	8
Plans & Department Listings	
NEW BUILDING / HAAREN HALL - L The Lobby Level	10
NEW BUILDING	
• Floors L3 & L2	12
• Floors 1 & 2	14
• Floors 3 & 4	16
• Floors 5 & 6	17
• Floors 7 & 8	18
• Floors 9 & 10	19
HAAREN HALL	
• Floors C & 1	20
• Floors 2 & 3	21
• Floors 4 & 5	22
• Floor 6	23
NORTH HALL	
• Floors 1 & 2	24
• Floors 3 & 4	25
WESTPORT	
• Floors 1 & 2	26
BMW	
• Floor 6	27
54TH ST. ANNEX	
• Floor 7	27

WELCOME
A Message from President Jeremy Travis



Today John Jay College of Criminal Justice stands at the threshold of a new chapter in our remarkable story. Founded in 1964 as a college to educate police officers in sciences and liberal arts, John Jay has transformed into the preeminent national and international leader in educating for justice –a broadly envisioned educational experience embracing social, economic, political, and criminal justice.

Every facet of John Jay drives our promise of educating for justice: Our students, with diverse backgrounds and interests, thrive on challenging educational opportunities with high social relevance. These students reflect the changing demographics of our country.

Our students define the College's character, they are: Determined, Courageous, Dynamic, and Strong. They are open to wherever their intellectual curiosity leads them and fierce advocates for justice.

Our faculty, with expertise in a range of academic disciplines, energizes and advances research and education. They offer an enriched learning experience that highlights the themes of justice across the arts, sciences and humanities, imparting strong moral sensibilities, sharp critical reasoning and creative problem-solving skills to our students.

A critical element in our transformation has been the construction of our new building. We have all watched it rise from an empty construction site on Eleventh Avenue to the magnificent structure that we see today. The expansion of our campus is already helping us to achieve long-sought academic and professional goals. This building is a critical underpinning of John Jay's transformation into a senior college and the greatest expression of our continued commitment to "educating for justice."

Let me share with you some of the specific aspects of our new building that make it so significant. Designed by Skidmore, Owings & Merrill, one of the top firms in the nation, the building is a stunning work of architecture that can proudly take its place among the great buildings of New York City.

This 620,000-square-foot building, 13-story vertical campus houses 56 state-of-the-art classrooms, new cyber lounges, computer labs, cutting edge science facilities, Emergency Management and High Rise Simulator labs, a moot court, conference rooms, the Anya and Andrew Shiva Gallery, a black box theater, the Lynn and Jules Kroll Atrium, great dining facilities and many other educational and administrative features in a 100 percent wireless environment.

The Jay Walk, cleverly named by our students, provides a remarkable outdoor rooftop commons where all members of the John Jay community can come together. Anchoring Haaren Hall to the new building and rising five stories above street level, this 60,000-square-foot park-like area features lawn space, trees and benches. We are also deeply honored that a World Trade Center Memorial sculpture was installed on this campus, one that commemorates the loss of over 60 members of our community on September 11, 2001.

The new building supports and fosters our commitment to educating for justice and enables the John Jay College community to prepare for the celebration of our 50th Anniversary next year. This is a tremendous time for John Jay. It is the culmination of many years of team effort and planning. The transformation of this College is dedicated to student success, teaching, research and scholarship, strategic partnerships and institutional effectiveness.

This Campus Guide provides additional details about our new building as well as all campus facilities and operations.

Thanks to the hard work and ongoing support of our outstanding faculty, students and staff, the future of John Jay is brighter than ever.

A handwritten signature in dark ink, appearing to read "Jeremy Travis".
President Jeremy Travis

CAMPUS SITE PLAN

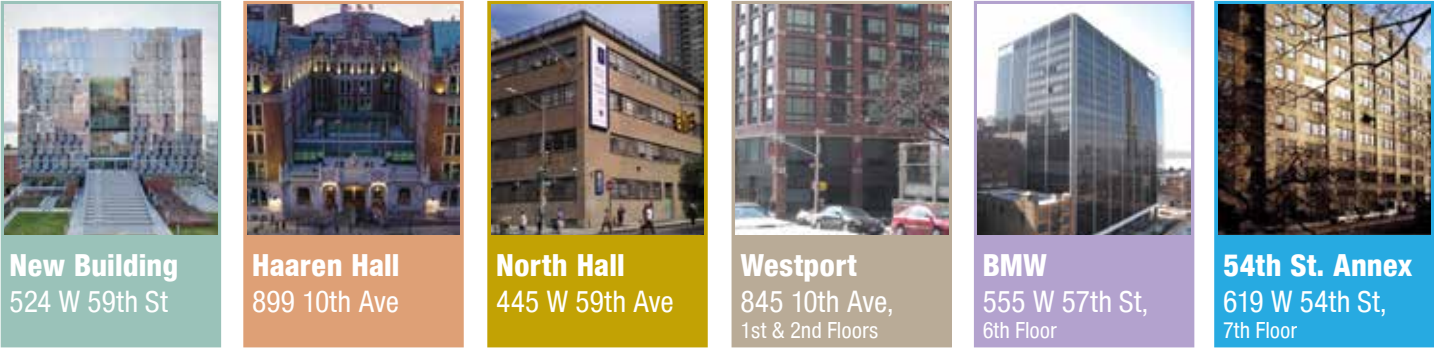
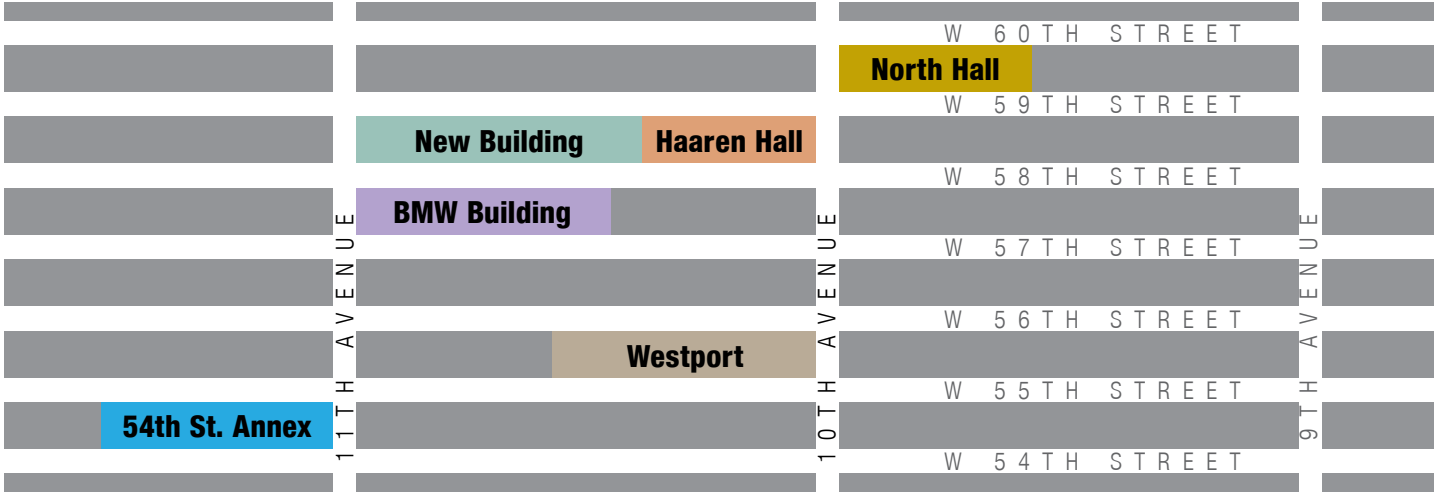

DEPARTMENT/OFFICE LOCATIONS (as of September 2013)

DEPARTMENT/OFFICE NAME	FLOOR	BUILDING	DEPARTMENT/OFFICE NAME	FLOOR	BUILDING
Academic Advisement Center / Justice Academy	L	New	Center on Terrorism / US Extremist Crime Database	6	BMW
Academic Affairs	6	Haaren	Central Receiving & Stockroom	L2	New
Academic Operations	6	BMW	Children's Center	L3	New
Accessibility Services	L	New	Classrooms	L2, L	New
Adjunct Resource Room	3	NH	Classrooms	1, 3, 8	New
Advancement of Research	6	BMW	Classrooms	1, 2, 3, 4	NH
Africana Studies	9	New	Classrooms	2	Westport
Alumni Association	6	Haaren, BMW	Combative Gymnasium	3	Haaren
Anthropology	9	New	Communication & Theater Arts	3	NH
Anthropology & Math Research	7	54th St. Annex	Communication & Theater Arts Labs	3	NH
Athletics Recreation and Intramurals	4	NH	Community Outreach and Service Learning	L	New
Art & Music	2, 4	NH	Conference Center	L	New
Audio Visual Services	1	NH	Counseling Services Center	L	New
Barnes & Noble College Bookstore	1	Westport	Criminal Justice	2	NH
Black Box Café	L2	New	Criminal Justice Doctoral Program	2	NH
Black Box Theater	L2	New	Criminal Justice Ethics	8	New
Bursar's Office	L	New	Dance Studio	C	Haaren
Cafeteria	2	New	DOIT (Department of Information Technology)	L2	New
Campus Office Services	L2	New	Development Through The Life Cycle	10	New
Center for Career & Professional Development	L	New	Dispute Resolution	3	NH
Center for Crime Prevention & Control	6	BMW	Economics	3	NH
Center for International Human Rights	6	BMW	English	7	New
Center for Protection Management	2	NH	Emergency & Security Management Lab	L2	New
Center for the Advancement of Teaching & Learning	3	NH	Enrollment Management	L	New
Center on Media Crime & Justice / The Crime Report	6	BMW	Extended College & Educational Partnerships	6	BMW
			External Affairs	1	NH

DEPARTMENT/OFFICE NAME	FLOOR	BUILDING	DEPARTMENT/OFFICE NAME	FLOOR	BUILDING
Facilities Management	L2	New	Philosophy	8	New
Facilities Management	1	NH	Political Science	9	New
Faculty & Staff Dining Room and Lounge	2	New	Pool	C	Haaren
Faculty Lounge	2	Westport	Pre-Law Institute	1	NH
Faculty Senate	1	NH	President's Office	6	Haaren
Faculty Senate	2	Haaren	Print Shop	C	Haaren
Finance & Administration	9	New	PRISM	5	New
Finance & Business Services	7	54th St. Annex	Prisoner Reentry Institute	6	BMW
Financial Aid	1	NH	PSC Office	1	NH
Fire Science Institute	6	BMW	Psychology	10	New
Fitness Center	6	Haaren	Psychology Research	2	NH
Foreign Languages	7	New	Psychology Research	7	54th St. Annex
Foreign Language Lab	7	New	Public Management	3	NH
Gallery	L3	New	Public Safety	L2	New
Gerald W. Lynch Theater	L	Haaren	Reflection Room	L2	New
Graduate Admissions	L	New	Registrar's Office	1	NH
Graduate Studies	6	BMW	Research & Evaluation Center	6	BMW
Grant Funded Programs	7	54th St. Annex	Running Track	Roof	Haaren
Gymnasium	4	Haaren	Science	3, 4, 5	New
Health & Physical Education	4	NH	Science Labs	3, 4, 5	New
Health Office	L	New	Science Quad	3	New
Highrise Simulator Lab	L2	New	Security, Fire, & Emergency Mgmt.	3	NH
History	8	New	Security Management Institute	6	BMW
Honors Program	8	New	SEEK (Search for Education, Elevation and Knowledge Program)	2, 3	NH
Human Resources	7	54th St. Annex			
Humanities Quad	8	New	Social Psychology	10	New
Institutional Research and Outcomes Assessment	6	BMW	Sociology	3	NH
Interdisciplinary Studies	6	New	Space Planning & Capital Projects	6	BMW
IRB (Institutional Review Board)	6	BMW	Special Programs Training Rooms	2	NH
ITSS & Computer Labs	L2	New	Sponsored Programs	6	BMW
Jay Express Services Center	L	New	Student Academic Services	1	Westport
Jay Express Svcs. Counter (formerly One Stop)	L	New	Student Academic Success Programs (SASP)	L2	New
Jay Walk (rooftop plaza)	2	New	Student Academic Success Programs (SASP)	1	Westport
JJ's Café	1	New	Student Affairs	L	New
JJ Online	6	BMW	Student Clubs & Organizations	L2	New
John Jay Sentinel	L2	New	Student Computer Lab	1	NH
Judicial Board	L2	New	Student Dining Hall	2	New
Justice Quad	6	New	Student Government	L2	New
Lactation Room	1	NH	Student Life	L2	New
Latin American and Latina/o Studies	8	New	Study Abroad	1	NH
Law & Police Science	4	Haaren	Tennis Court	6	Haaren
Law & Police Science Computer Labs	4	Haaren	Terraces	2	Westport
Legal Counsel	6	Haaren	Testing Offices & Labs	L	New
Library	L	Haaren	Theater Lobby	L	New
Lounge (Student Lounge)	1	New	Training Rooms	6	BMW
Mailroom	L2	New	TV Studio	3	Haaren
Marketing & Development	6	Haaren, BMW	Undergraduate Admissions	L	New
Math & Science Resource Center	1	New	Undergraduate Studies	6, 8	New
Mathematics	6	New	Urban Male Initiative	L	New
McNair Program	9	New	Vatea Program	3	NH
Moot Court	6	New	Veterans' Services	3	NH
Perkins Grant	3	NH	Weight Room	C	Haaren
PDP Lab (Professional Development Program)	L	New	Women's Center	L	New
PhD Psychology	10	New	Writing Center	1	New
			Writing Center's Workshop Rooms	1	New

BUILDING HOURS

ACCESS HOURS FOR STUDENTS & STAFF

New Building, North Hall, Haaren Hall & Westport

Mon. thru Thurs. 7:00 am - 11:00 pm

Friday 7:00 am - 9:00 pm

Saturday 7:00 am - 6:30 pm

Sunday (New Building and Haaren Hall only)
8:00 am - 5:30 pm

BMW Building & 54th St. Academic Annex

Mon. thru Thurs. 7:00 am - 11:00 pm

Friday 7:00 am - 9:00 pm

Saturday 7:00 am - 7:00 pm

ACCESS HOURS FOR FACULTY IN ALL FACILITIES

Daily: 7 days/week 6:00 am – 12:00 am (midnight)

Faculty are required to sign in with the Public Safety Office should they enter or remain on the campus outside of the normal hours.

PUBLIC SAFETY & OPERATIONAL INFORMATION

VIDEO SECURITY MANAGEMENT SYSTEM

The College is protected by surveillance cameras that are strategically placed throughout the campus.

EMERGENCY SYSTEM

FOR EMERGENCY ONLY - Dial 8888 on any College phone. Phones are located in all classrooms throughout the campus as well as elevator vestibules of Haaren Hall, North Hall and Westport. All have a direct connection to the Public Safety desks. Restrooms are equipped with panic buttons and/or emergency phones which connect with the Public Safety desks without dialing.

You can call Public Safety at 212-237-8524.

NO SMOKING

John Jay College is a No Smoking Facility. There is no smoking permitted within 25 feet of all entrances. There is no smoking on the New Building Jay Walk outdoor plaza or terraces at the Westport facility.

FIRE EXITS

Fire Exit Information is displayed on maps on the wall nearest to the entrance in all classrooms.

ID AND TURNSTILE SYSTEM

A valid ID is required for access to the College. The College has an integrated access control system therefore the same ID card can be used in every campus building.

Visitors to the College or persons who have lost or forgotten their ID card must present a form of photo identification. After stating their business at the College they are required to sign in. This also includes guests accompanied by members of the College community. Visitors will be announced to the person they are visiting where appropriate. Visitors from any other CUNY College must show their ID card and the sign in procedures are waived. All members of the College community are encouraged to submit the names of expected guests to the Department of Public Safety ahead of the visit in order to expedite the individual's admission to the college.

For more information on Public Safety please visit www.jjay.cuny.edu/security.php

DEPARTMENT RELOCATION NEWS & SCHEDULE

Although the move to the New Building is complete, the College continues to undergo office relocations and space re-organizations as a result of a major Haaren Hall renovation project which involves extensive renovation of the 3rd, 4th, 5th, and 6th floor wings plus total heating, ventilation, and cooling system equipment replacement. Many academic and administrative departments and offices have been temporarily moved to North Hall for the duration of the renovation. The project is expected to be completed in Fall 2014 at which time the relocated departments will move back to their Haaren Hall areas. For the updates on progress, go to the College's website at <http://www.jjay.cuny.edu/4808.php>

DINING OPTIONS

DINING FACILITIES

Whether you want to have a grab-and-go sandwich or to sit down for a chat with your classmates over lunch - we have it all!

The College provides a variety of easily accessible dining facilities in several locations throughout the campus.

New Building

Student Dining Hall - Floor 2

Faculty and Staff Dining - Floor 2

JJ's Café - Floor 1 (Classroom level)

Black Box Café - L2

Haaren Hall

Café - 2nd Floor

North Hall

JJ's North Food Kiosk - Lobby Level

Westport Building

Café - Street Level

Snack and beverage vending machines are available throughout the campus.

TOUCH SCREEN WAY-FINDING KIOSKS

The kiosks include faculty/staff/department listings, calendar/event/announcement postings, campus map in 2D format and dynamic way-finding map paths along with the capability to link map paths with individuals or departments.

LOCATIONS

New Building

L3 - 11th Avenue Entrance

L2 - by the Black Box Theater

L - by 59th street entrance in Lobby

Floor 1 - by the JJ's Café

Floor 2 - by Cafeteria

Lobby in Haaren Hall by the wall



59th Street Entrance



Jay Express Service Counter



Conference Room on Floor 9



Classroom



Kroll Atrium



Computer Lab



Lecture Hall

New Building with Haaren Hall (as of September 2013)

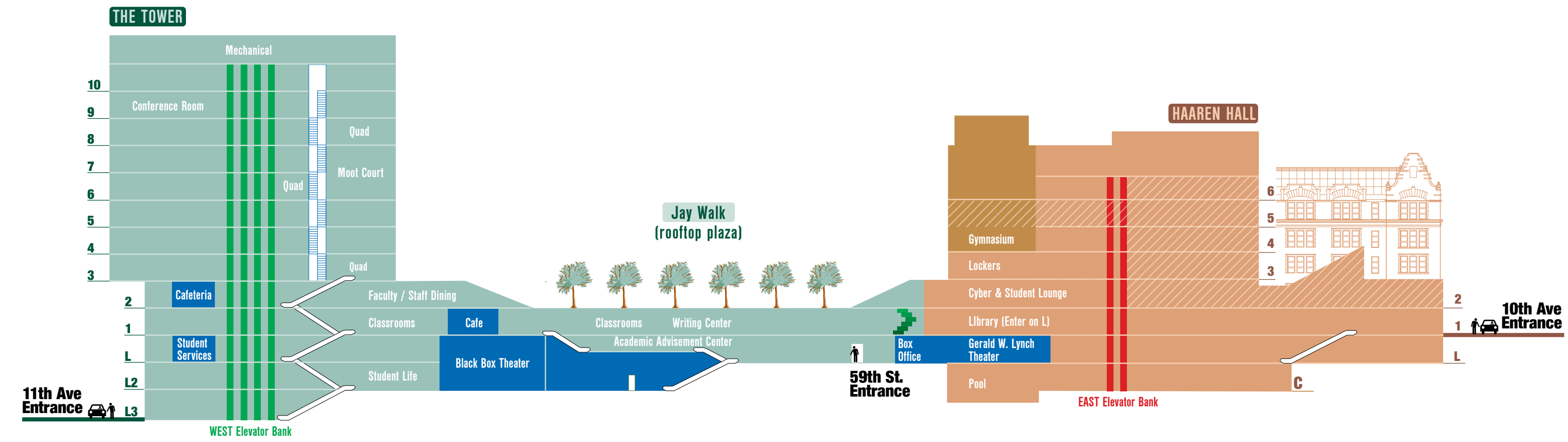

DEPARTMENT/OFFICE NAME	FLOOR	BUILDING	DEPARTMENT/OFFICE NAME	FLOOR	BUILDING	DEPARTMENT/OFFICE NAME	FLOOR	BUILDING	DEPARTMENT/OFFICE NAME	FLOOR	BUILDING
Academic Advisement Center/Justice Academy	L	New	Emergency & Security Management Lab	L2	New	John Jay Sentinel	L2	New	Public Safety	L2	New
Academic Affairs	6	Haaren	Enrollment Management	L	New	Judicial Board	L2	New	Reflection Room	L2	New
Accessibility Services	L	New	Facilities Management	L2	New	Justice Quad	6	New	Running Track	Roof	Haaren
Africana Studies	9	New	Faculty & Staff Dining Room and Lounge	2	New	Latin American and Latina/o Studies	8	New	Science	3, 4, 5	New
Alumni Association	6	Haaren	Faculty Senate	2	Haaren	Law & Police Science	4	Haaren	Science Labs	3, 4, 5	New
Anthropology	9	New	Finance & Administration	9	New	Law & Police Science Computer Labs	4	Haaren	Science Quad	3	New
Black Box Café	L2	New	Fitness Center	6	Haaren	Legal Counsel	6	Haaren	Social Psychology	10	New
Black Box Theater	L2	New	Foreign Languages	7	New	Library	L	Haaren	Student Academic Success Programs (SASP)	L2	New
Bursar's Office	L	New	Foreign Language Lab	7	New	Lounge (Student Lounge)	1	New	Student Affairs	L	New
Cafeteria	2	New	Gallery	L3	New	Mailroom	L2	New	Student Clubs & Organizations	L2	New
Campus Office Services	L2	New	Gerald W. Lynch Theater	L	Haaren	Marketing & Development	6	Haaren	Student Dining Hall	2	New
Center for Career & Professional Development	L	New	Graduate Admissions	L	New	Math & Science Resource Center	1	New	Student Government	L2	New
Central Receiving & Stockroom	L2	New	Gymnasium	4	Haaren	Mathematics	6	New	Student Life	L2	New
Children's Center	L3	New	Health Office	L	New	McNair Program	9	New	Tennis Court	6	Haaren
Classrooms	L2, L	New	Highrise Simulator Lab	L2	New	Moot Court	6	New	Testing Offices & Labs	L	New
Classrooms	1, 3, 8	New	History	8	New	PDP Lab (Professional Development Program)	L	New	Theater Lobby	L	New
Combative Gymnasium	3	Haaren	Honors Program	8	New	PhD Psychology	10	New	TV Studio	3	Haaren
Community Outreach and Service Learning	L	New	Humanities Quad	8	New	Philosophy	8	New	Undergraduate Admissions	L	New
Conference Center	L	New	Interdisciplinary Studies	6	New	Political Science	9	New	Undergraduate Studies	6, 8	New
Counseling Services Center	L	New	ITSS & Computer Labs	L2	New	Pool	C	Haaren	Urban Male Initiative	L	New
Criminal Justice Ethics	8	New	Jay Express Services Center	L	New	President's Office	6	Haaren	Weight Room	C	Haaren
Dance Studio	C	Haaren	Jay Express Svcs. Counter (formerly One Stop)	L	New	Print Shop	C	Haaren	Women's Center	L	New
DOIT (Department of Information Technology)	L2	New	Jay Walk (rooftop plaza)	2	New	PRISM	5	New	Writing Center	1	New
Development Through The Life Cycle	10	New	JJ's Café	1	New	Psychology	10	New	Writing Center's Workshop Rooms	1	New
English	7	New									

New Building

L - The Lobby Floor (connecting New Building and Haaren Hall)

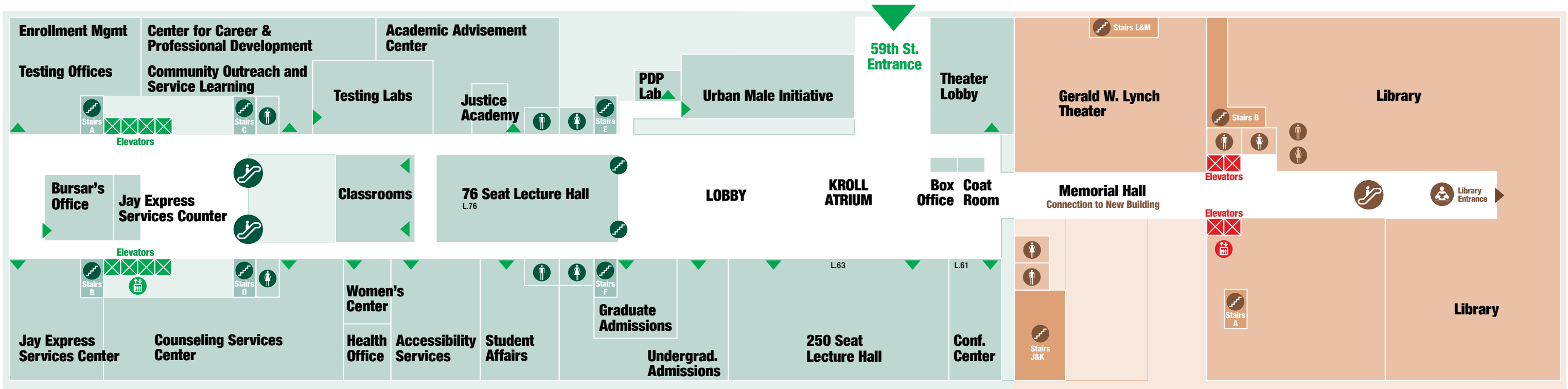

- Academic Advisement Center
- Accessibility Services
- Box Office
- Bursar's Office
- Center for Career & Professional Development
- Classrooms
- Community Outreach and Service Learning
- Conference Center
- Counseling Services Center
- Enrollment Management
- Graduate Admissions
- Health Office
- Jay Express Services Center
- Jay Express Svcs. Counter (formerly One Stop)
- Justice Academy
- Lecture Hall
- PDP Lab (Professional Development Program)
- Student Affairs
- Testing Offices & Labs
- Theater Lobby
- Undergraduate Admissions
- Urban Male Initiative
- Women's Center

- MAJOR FEATURES
- 100% wireless Environment
 - 250 Seat Lecture Hall
 - Black Box Theater
 - Jay Walk (rooftop plaza)
 - Student Services on entrance floor
 - Moot Court
 - Connection to Haaren Hall at 3 floors
 - New & Expanded Science Facilities on 3 floors
 - Emergency Management and High Rise Simulator Labs
 - Kroll Atrium

Haaren Hall - Lobby Level

- Library
- Gerald W. Lynch Theater
- Memorial Hall (Home of 9/11 Memorial)

- MAJOR FEATURES
- Tennis Court and Running Track
 - Gymnasium and Fitness Center
 - Theater
 - Library
 - Pool
 - TV Studio
 - Memorial Hall

New Building Floor L3

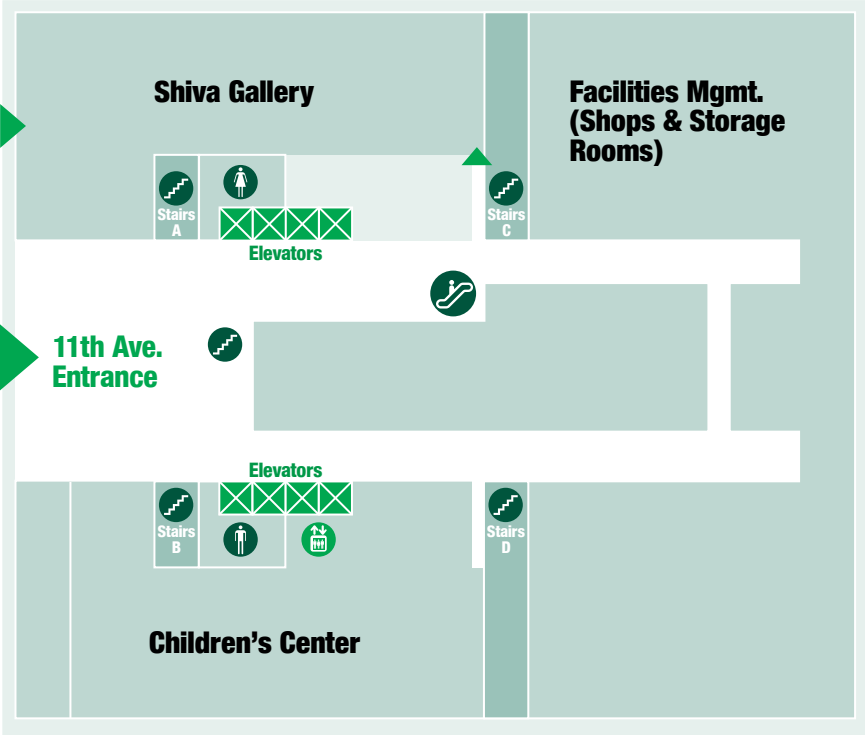

Children's Center
Facilities Management
(Shops & Storage Rooms)
Shiva Gallery



11th Ave Lobby

New Building Floor L2

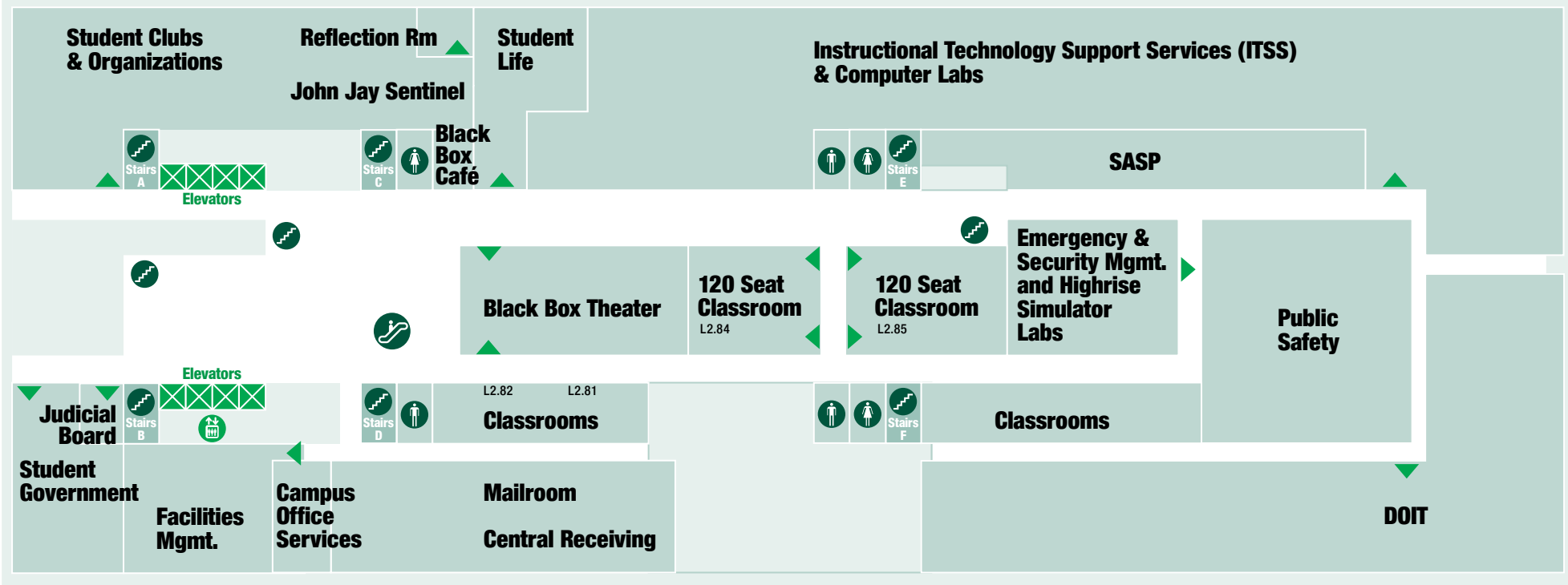

120 Seat Classroom on Floor L2

- Black Box Café
- Black Box Theater
- Campus Office Services
- Central Receiving
- Classrooms
- DOIT (Department of Information Technology)
- Emergency & Security Management Lab
- Facilities Management
- Highrise Simulator Lab
- Instructional Technology Support Services (ITSS) & Computer Labs
- John Jay Sentinel
- Judicial Board
- Mailroom
- Public Safety
- Reflection Room
- Student Academic Success Programs (SASP)
- Student Life
- Student Clubs & Organizations
- Student Government

New Building Floor 1

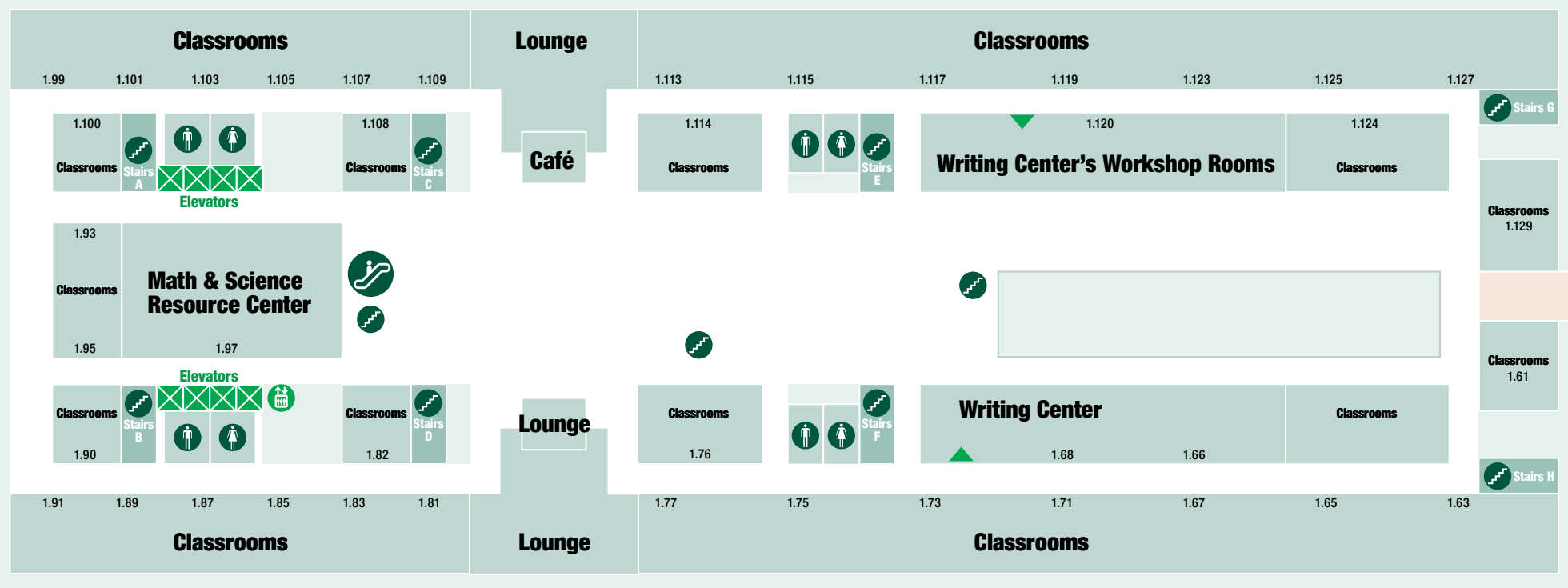

- Classrooms
- JJ's Café
- Lounge
- Math & Science Resource Center
- Writing Center
- Writing Center's Workshop Rooms

New Building Floor 2



- Faculty & Staff Dining Room
- Faculty & Staff Lounge
- Jay Walk
- Student Dining Hall

*
Floor 2
Connection to Haaren Hall



DID YOU KNOW?

The New Building's outdoor rooftop commons, called Jay Walk, provides the College with an outdoor area - as large as a football field - with lawns, trees and benches. A green oasis for John Jay's community in the middle of New York City, this remarkable space provides an inviting and unique outdoor experience, where students, faculty and staff can mingle, enjoy conversation and build a greater sense of community.

New Building Floor 3

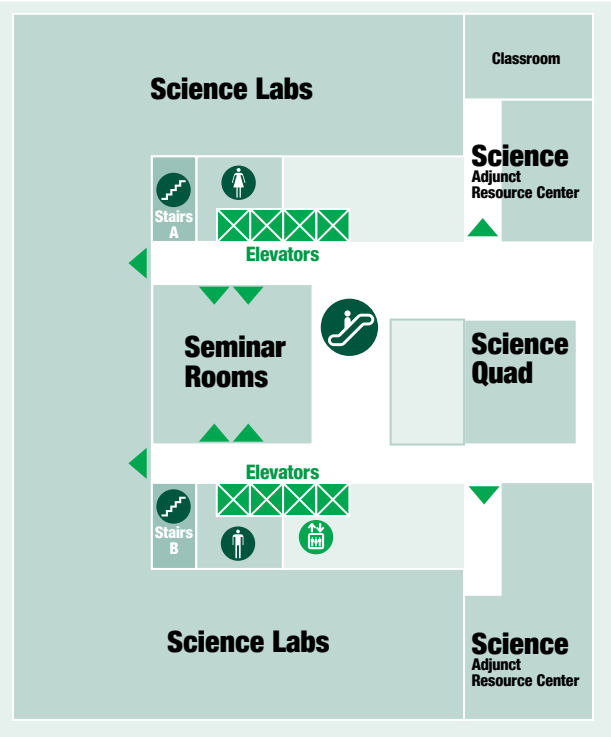

- Classrooms
- Science Adjunct Resource Center
- Science Labs
- Science Quad
- Seminar Rooms

New Building Floor 5

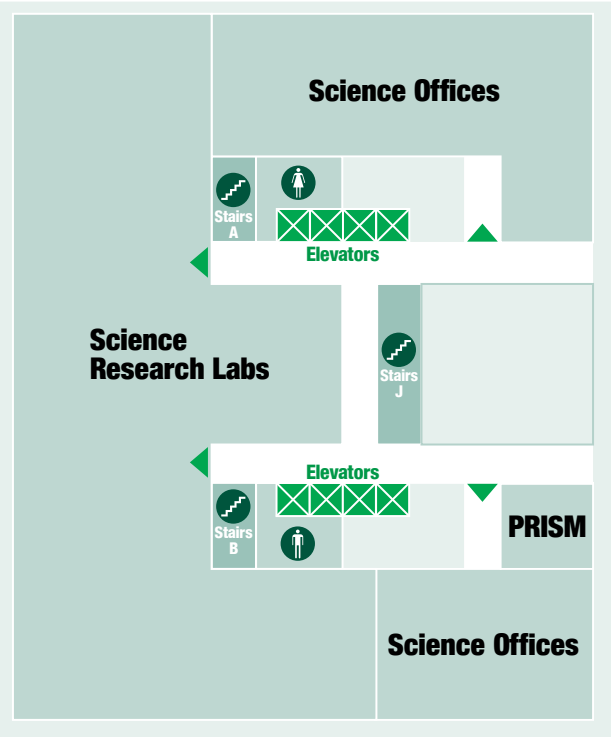

- PRISM
- Science Offices
- Science Research Labs

New Building Floor 4

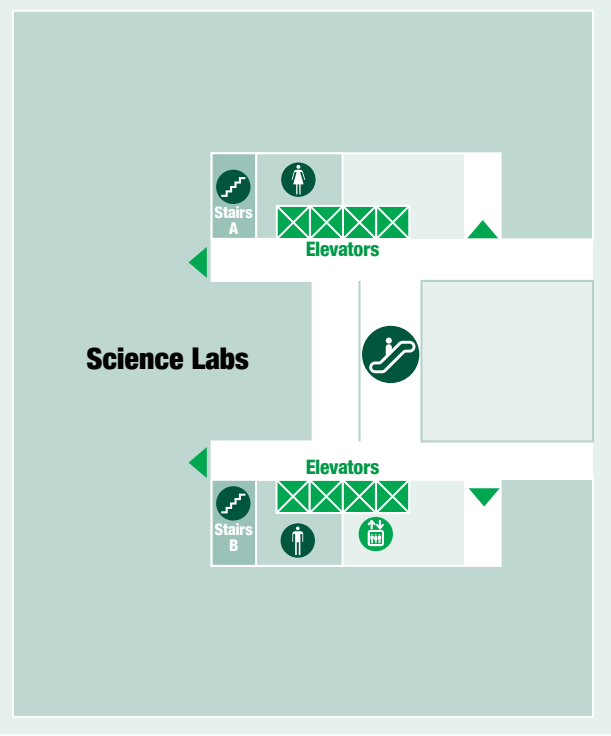

Science Labs

New Building Floor 6

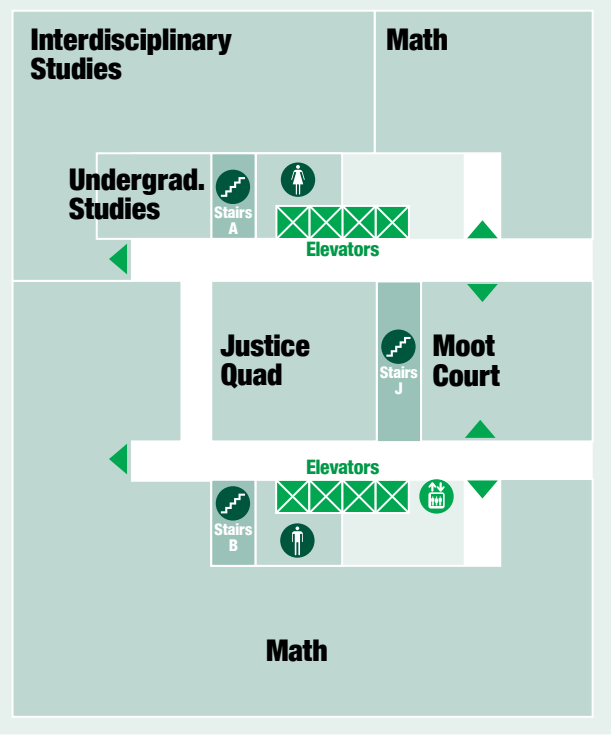

- Gender Studies
- Interdisciplinary Studies
- Justice Quad
- Math
- Moot Court
- Undergraduate Studies

New Building Floor 7

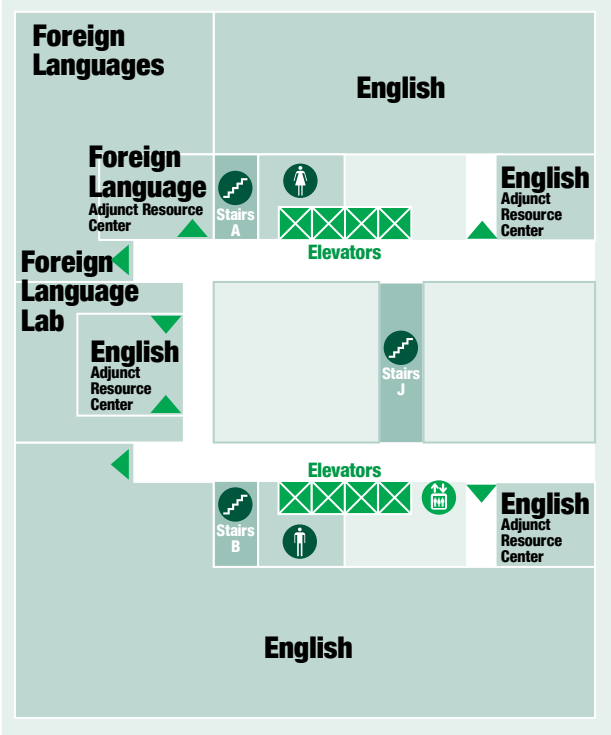

English Faculty Offices
English Adjunct Resource Center
Foreign Language Adjunct Resource Center
Foreign Language Faculty Offices
Foreign Language Lab

New Building Floor 9

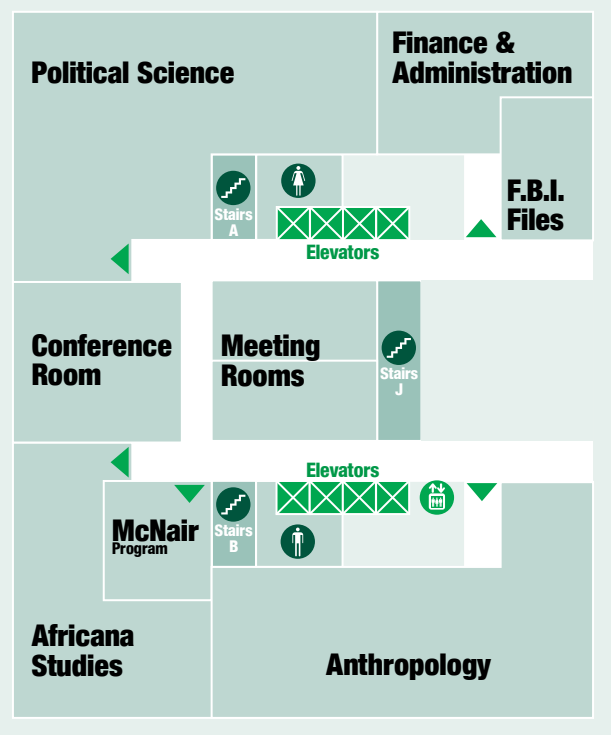

Africana Studies
Anthropology
Conference Room
F.B.I. Files
Finance & Administration
McNair Program
Meeting Rooms
Political Science
Psychology

New Building Floor 8

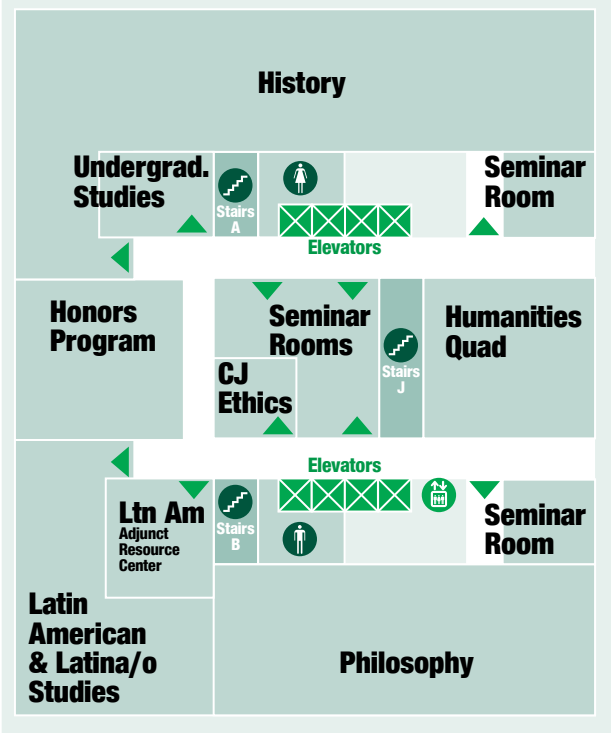

C.J. Ethics
History
Honors Program
Humanities Quad
Latin American & Latina/o Studies
Philosophy
Undergraduate Studies

New Building Floor 10

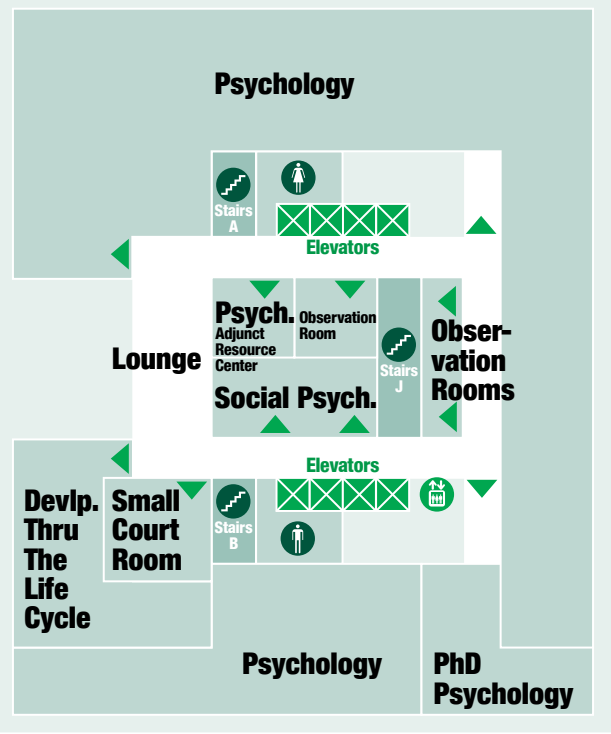

Development Through The Life Cycle
Observation Rooms
PhD Psychology
Psychology Adjunct Resource Center
Psychology
Small Court Room
Social Psychology

Haaren Hall Floor C

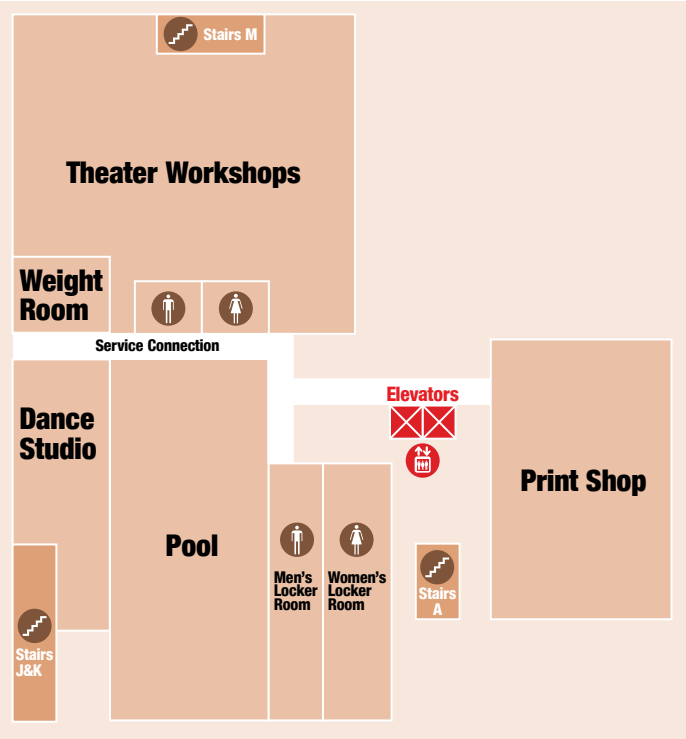

Dance Studio
Locker Rooms
Pool
Print Shop
Theater Workshops
Weight Room

Haaren Hall Floor 2

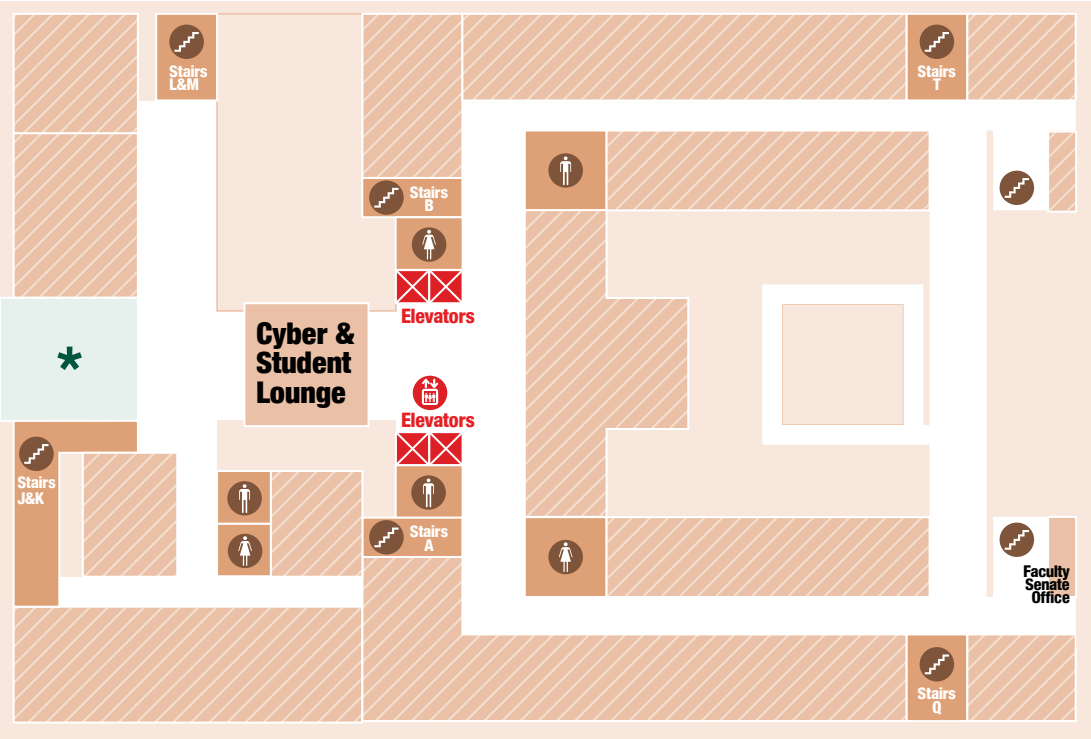

Cyber & Student Lounge
Faculty Senate Office

* Connection (Stairs) to New Building Floor 1

Under Construction

Haaren Hall Floor 1

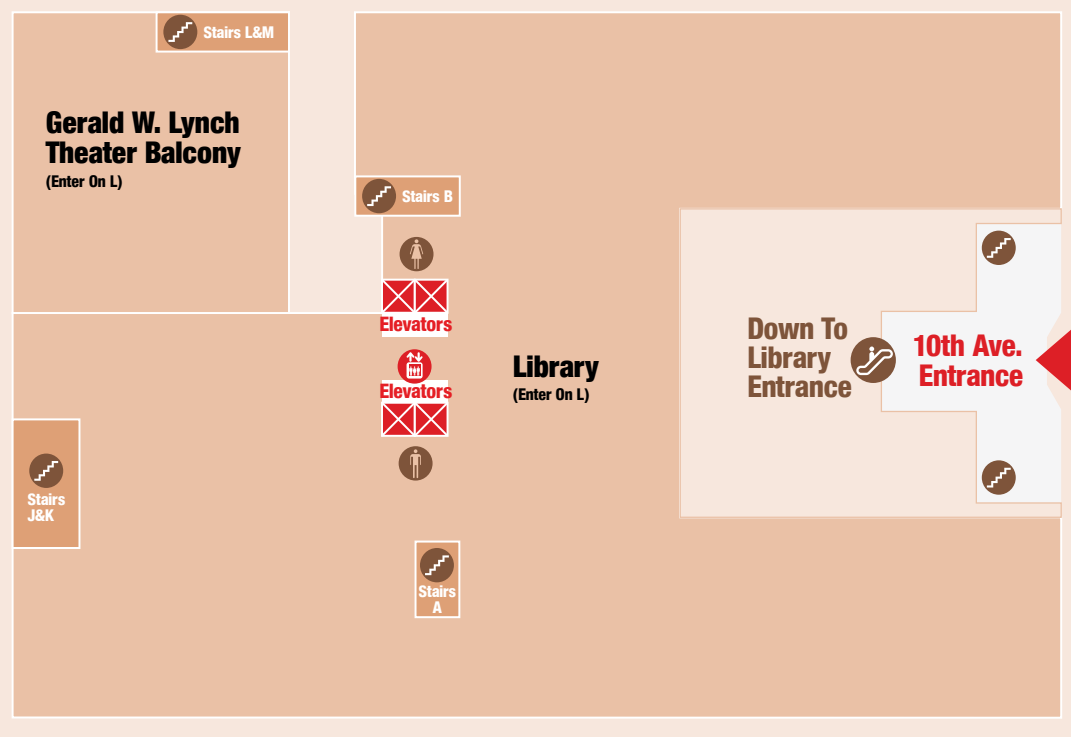

10th Ave Entrance (Escalator Down To Library Entrance)



The Gerald W. Lynch Theater is a 600 seat state-of-the-arts performing art venue committed to providing diverse artistic and scholarly events that educate, entertain and involve our academic and public communities.

Haaren Hall Floor 3

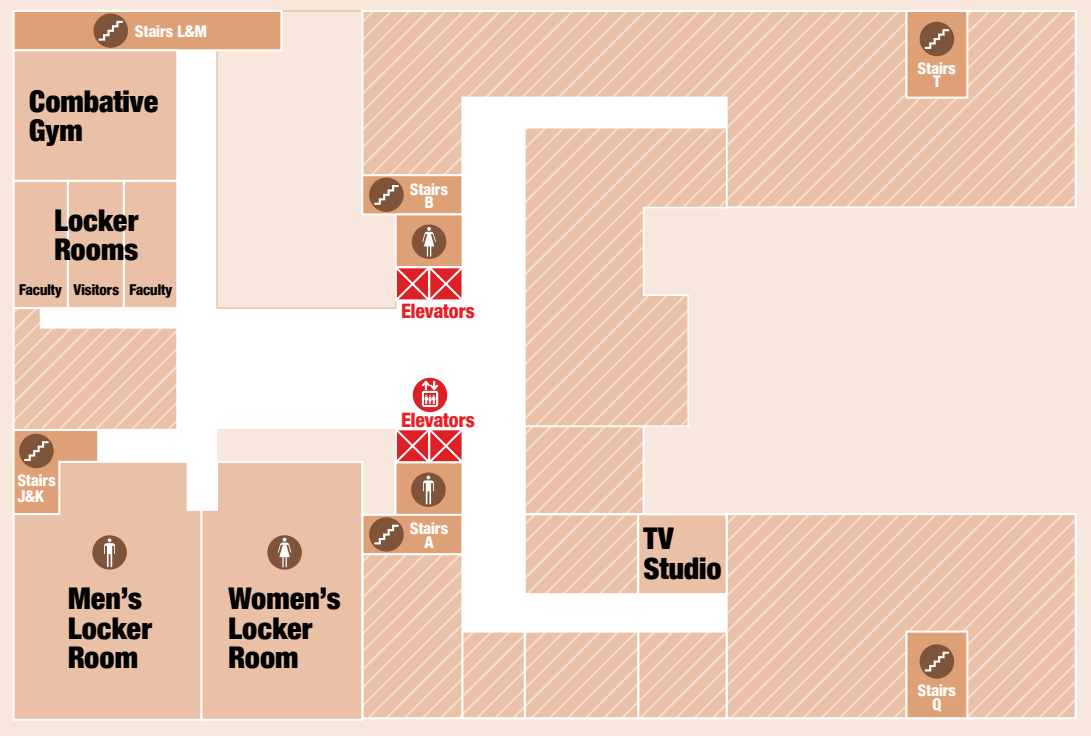

Combative Gymnasium
Locker Rooms
TV Studio

Under Construction

Haaren Hall Floor 4

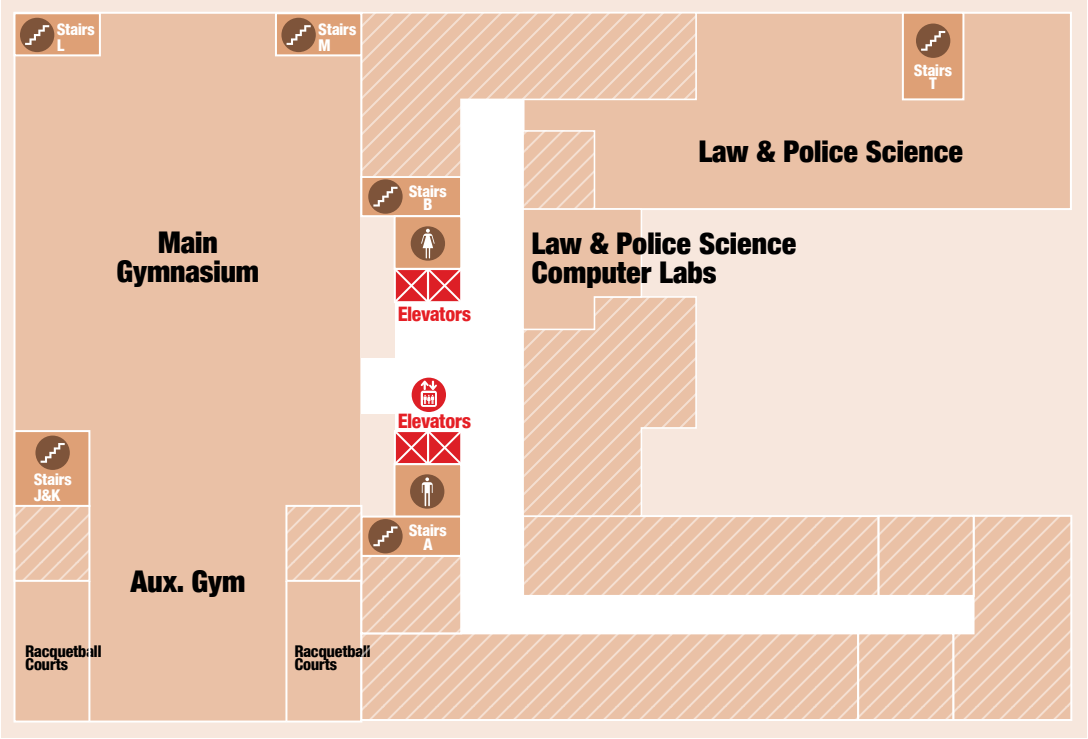

- Gymnasium
 - Law & Police Science
 - Law & Police Science
 - Computer Labs
- Under Construction

Haaren Hall Floor 6

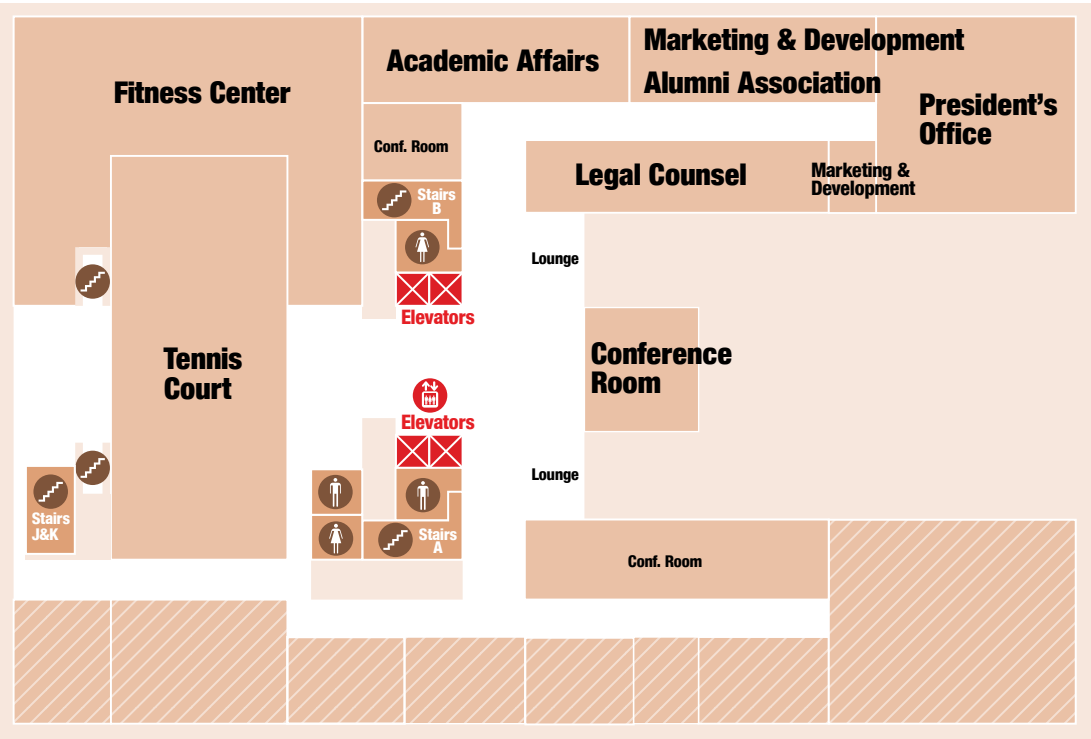

- Academic Affairs
 - Alumni Association
 - Fitness Center
 - Legal Counsel
 - Marketing & Development
 - President's Office
 - Tennis Court
- Under Construction

Haaren Hall Floor 5 CLOSED FOR RENOVATION

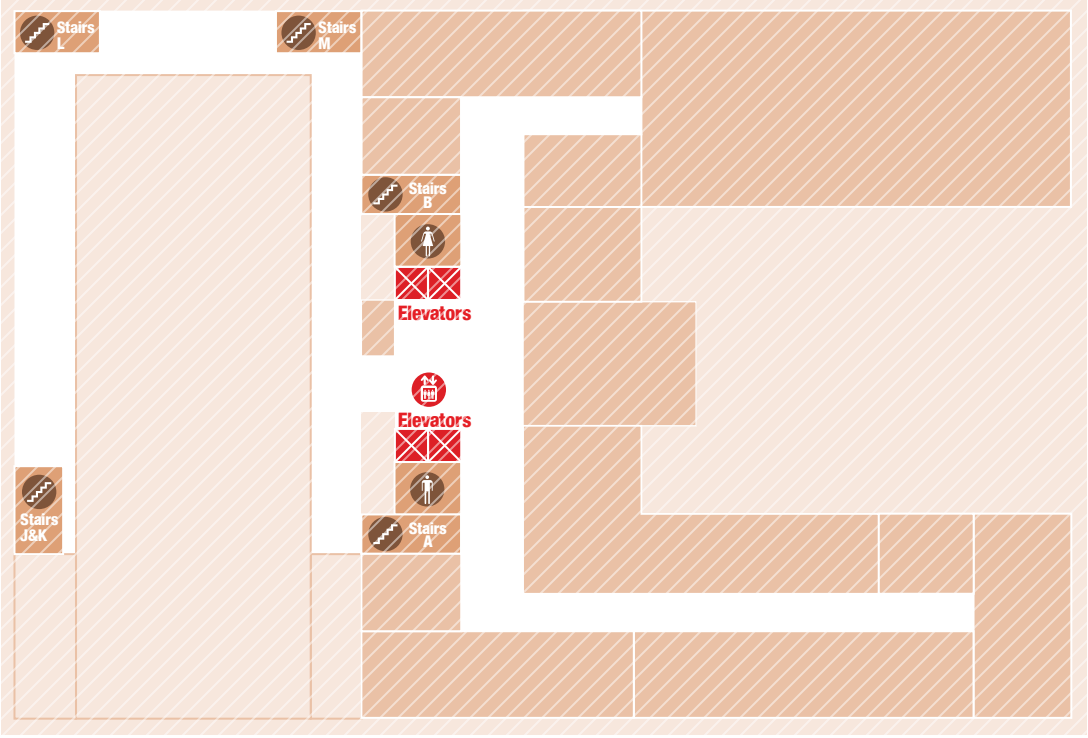

DID YOU KNOW?

Before becoming home of John Jay College in 1988, Haaren Hall used to be Haaren High School.

Haaren Hall facilities have been used for dozens of high-profile events, films and shows, including addresses by Secretary of State Hillary Clinton, TV programs like 30 Rock, Law & Order, Blue Bloods, Celebrity Apprentice, White Collar, commercials, HBO, Comedy Central, and several movies.

North Hall Floor 1

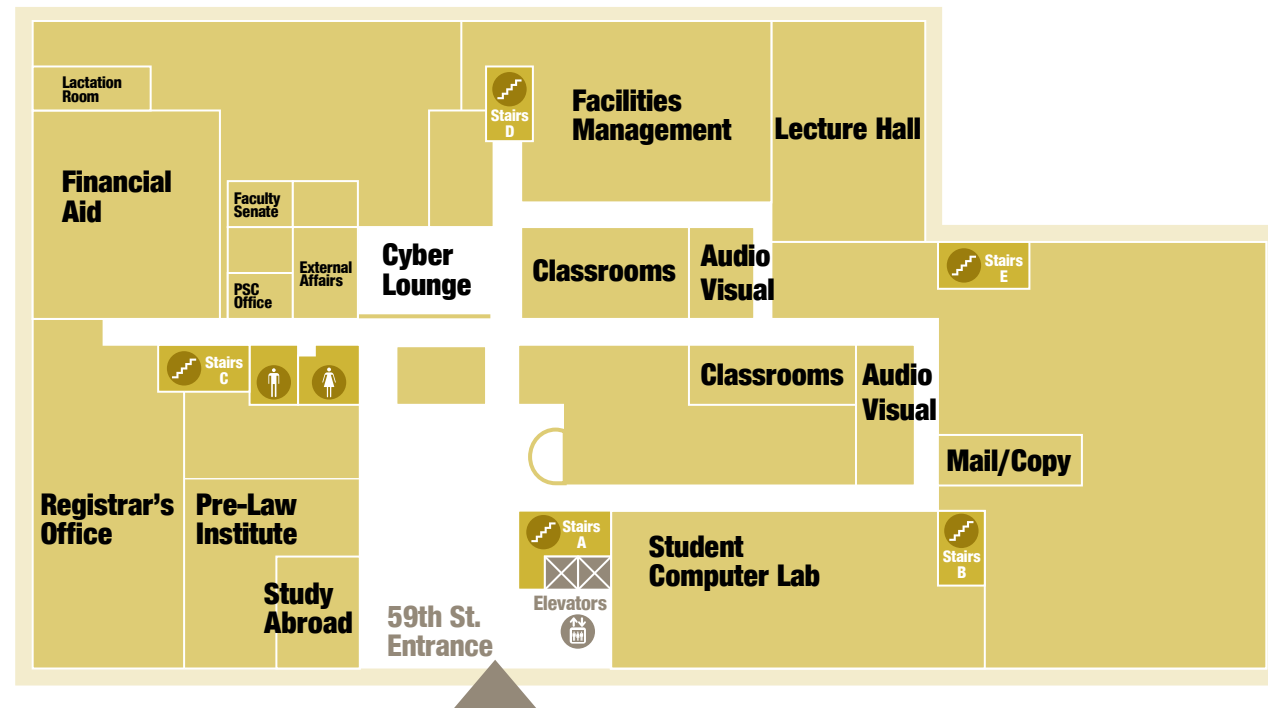

- Audio Visual
- Classrooms
- Cyber Lounge
- External Affairs
- Facilities Mgmt.
- Faculty Senate
- Financial Aid
- Lactation Room
- Lecture Hall
- Mail/Copy Room
- Pre-Law Institute
- PSC Office
- Registrar's Office
- Student Computer Lab

The North Hall will serve as a temporary home for some academic and administrative departments through September 2014 due to a major College space re-organization and renovation plan. It will eventually become the site of CUNY's new community college.

Visit www.jjay.cuny.edu/4808.php for more details.

North Hall Floor 2

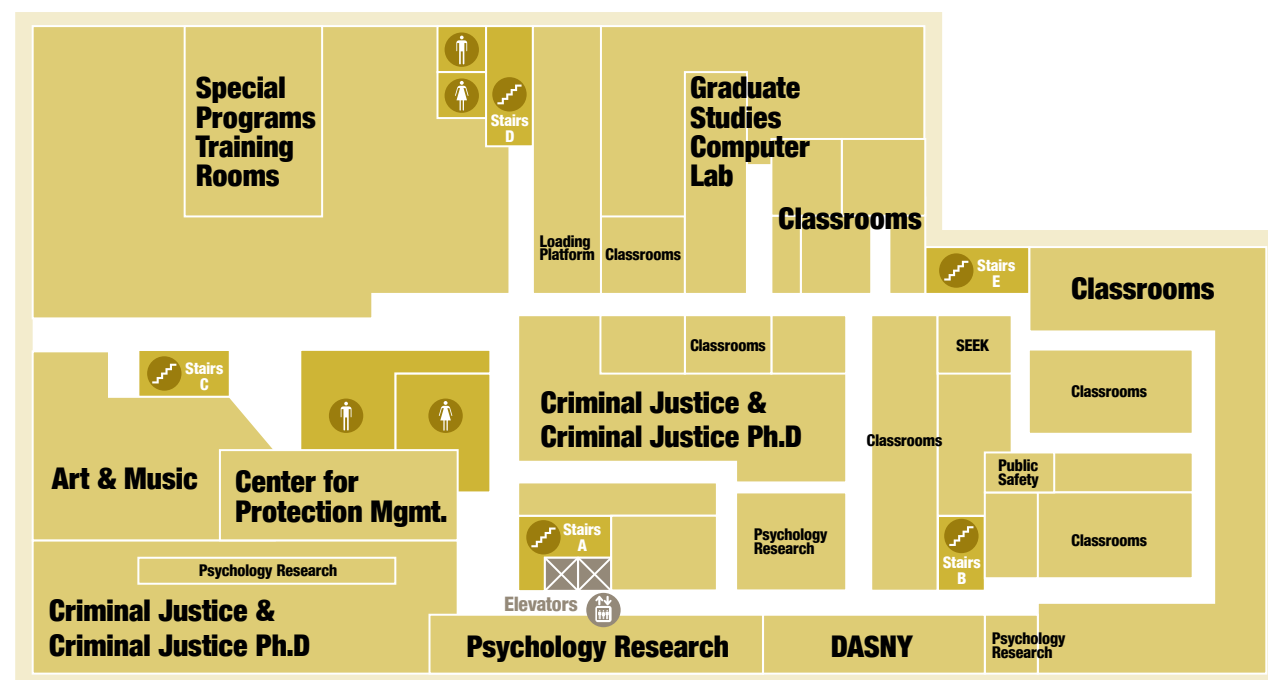

- Art & Music
- Center for Protection Mgmt.
- Classrooms
- Criminal Justice
- Criminal Justice Ph.D
- DASNY
- Graduate Studies
- Computer Lab
- Loading Platform
- Psychology Research
- SEEK
- Special Programs
- Training Rooms

North Hall Floor 3

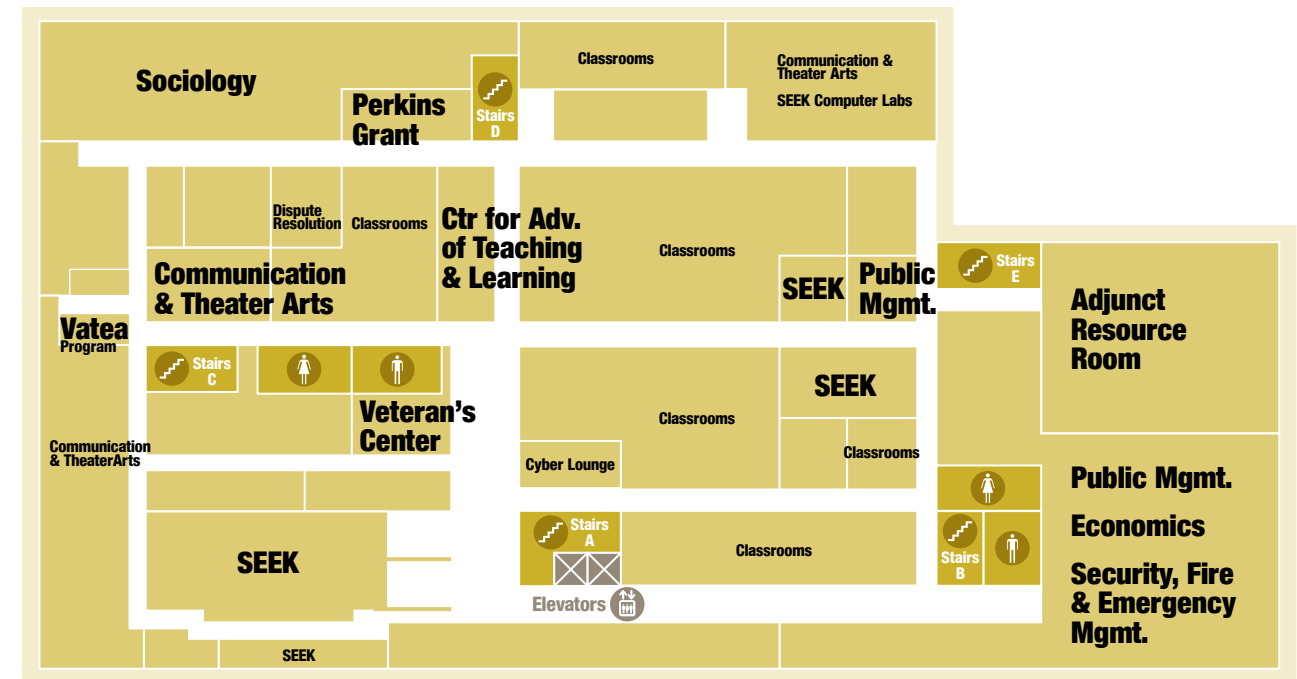

- Adjunct Resource Room
- Center for Adv. of Teaching & Learning
- Classrooms
- Communication & Theater Arts
- Cyber Lounge
- Dispute Resolution
- Economics
- Perkins Grant
- Public Mgmt.
- Security, Fire & Emergency Mgmt.
- Sociology
- SEEK
- Vatea Program
- Veteran's Center

MAJOR FEATURES

Academic and Administrative Offices

Cyber Lounges

Student Computer Lab

DID YOU KNOW?

Before John Jay College acquired North Hall, it used to be a shoe factory!

North Hall Floor 4

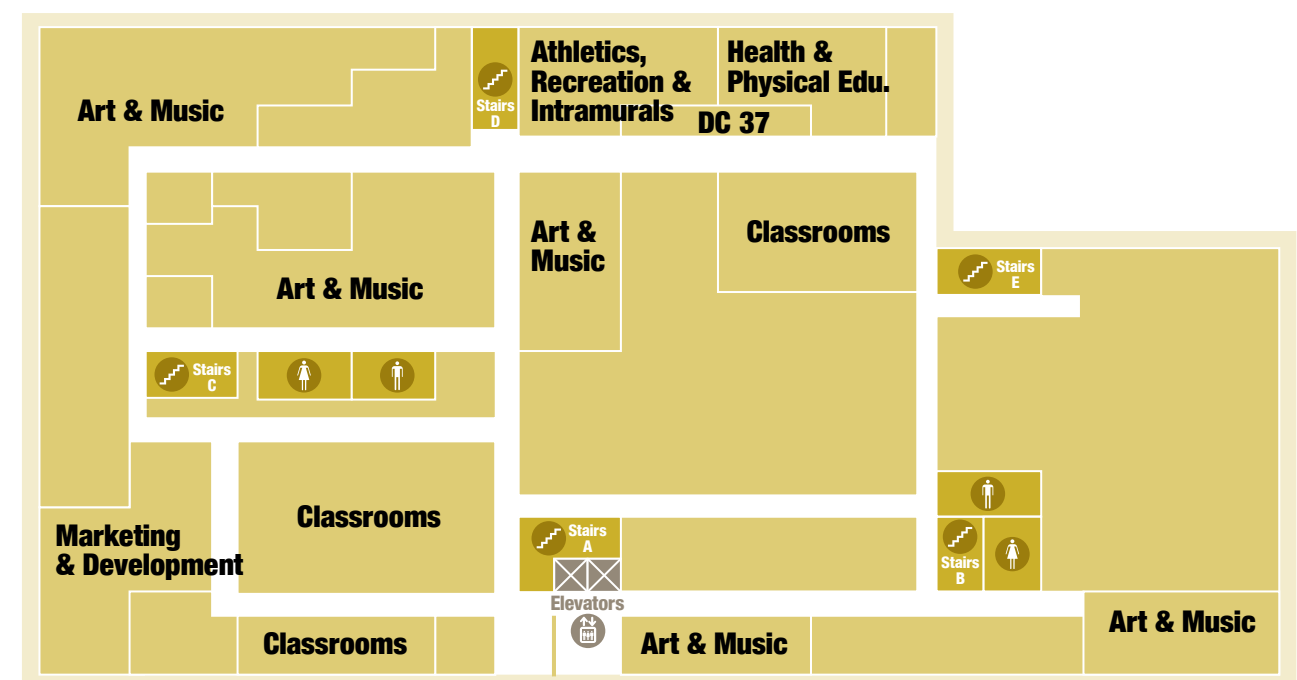

Art & Music
Athletics, Recreation
& Intramurals
Classrooms
DC 37
Health & Physical
Education
Marketing &
Development

Westport Floor 1

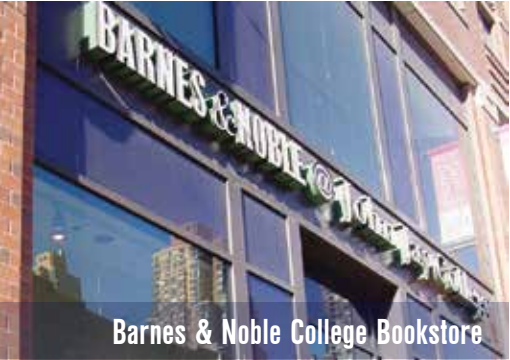
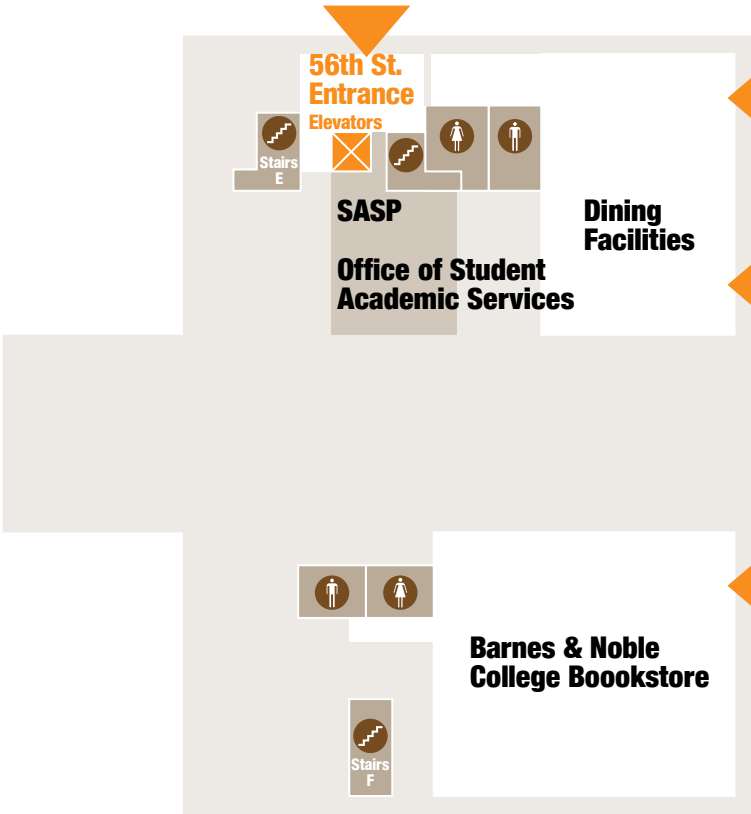

Barnes & Noble College Bookstore
Dining Facilities
Office of Student Academic Services
Student Academic Success Programs (SASP)

Westport Floor 2

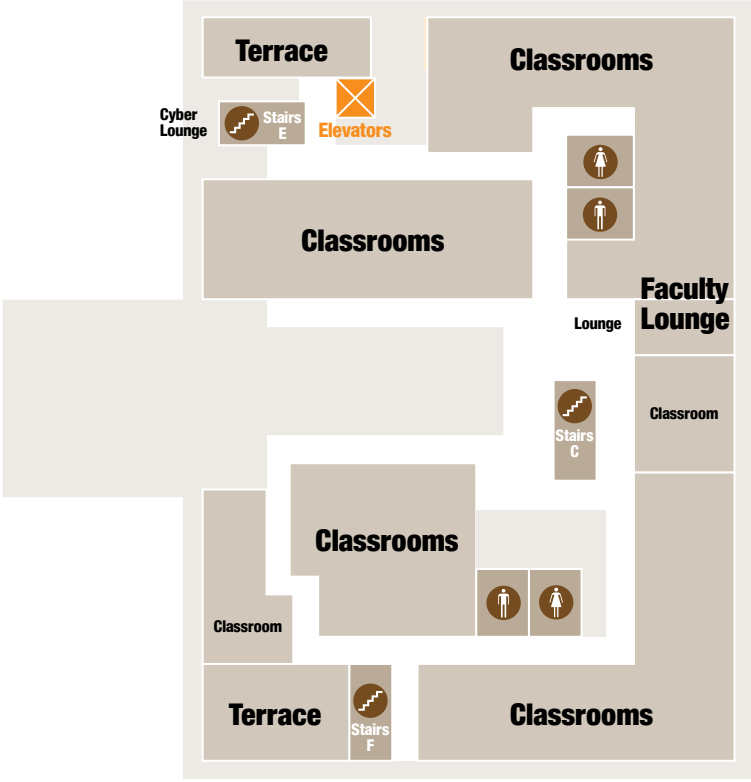

Classrooms
Cyber Lounge
Faculty Lounge
Lounge
Terraces

MAJOR FEATURES

- Barnes & Noble College Bookstore
- Dining Facilities
- Outdoor Terraces

BMW Floor 6

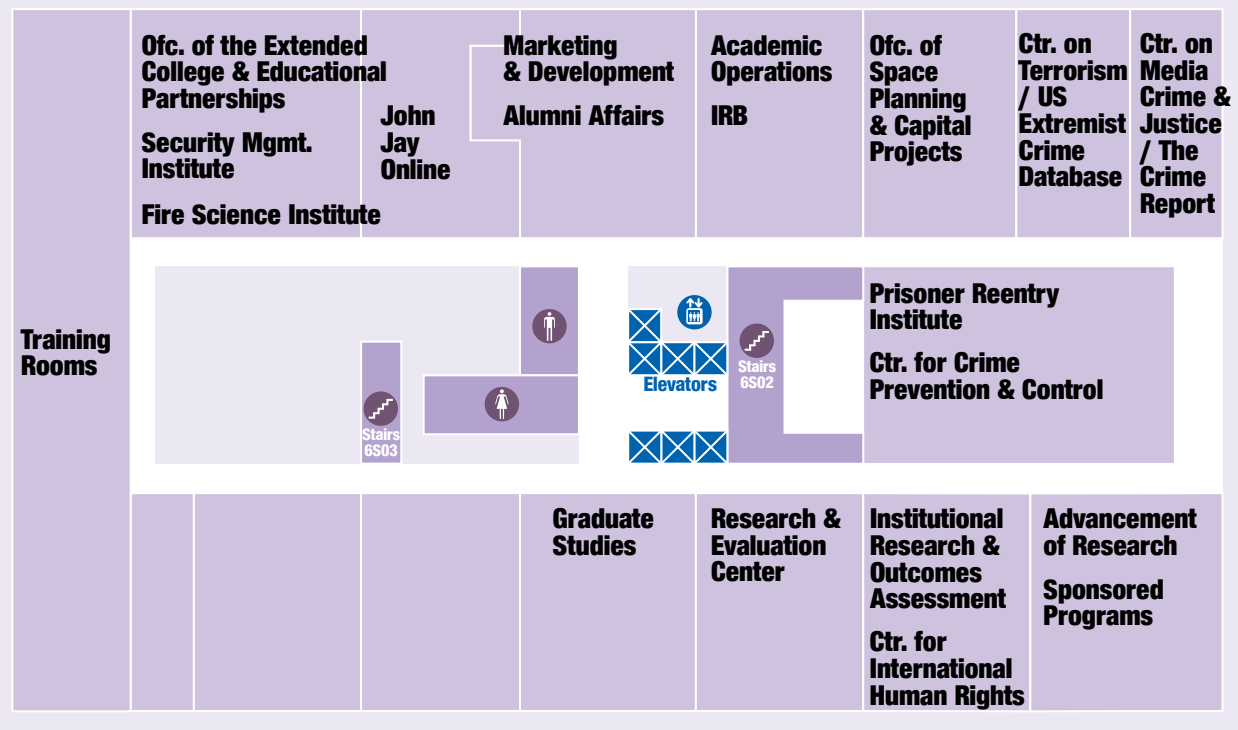

Academic Operations
Advancement of Research
Alumni Affairs
Center for Crime Prevention & Control
Center for International Human Rights
Center on Media Crime & Justice / The Crime Report
Center on Terrorism / US Extremist Crime Database
Fire Science Institute
Graduate Studies
Institutional Research & Outcomes Assessment
IRB
John Jay Online
Marketing & Development
Office of Space Planning & Capital Projects
Office of Extended College & Educational Partnerships
Prisoner Reentry Institute
Research & Evaluation Center
Security Management Institute
Sponsored Programs
Training Rooms

54th St. Annex Floor 7

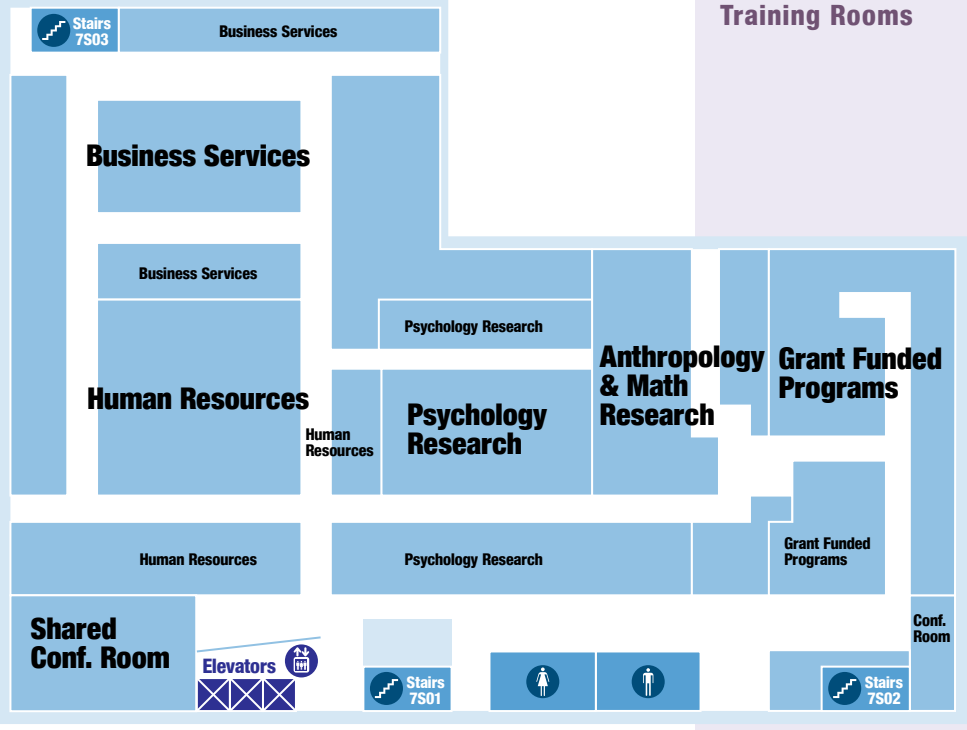

MAJOR FEATURES

- Academic Centers
- Training Rooms

DID YOU KNOW?

BMW will serve as a temporary home for many academic and administrative departments through September 2014 due to College's space re-organization and renovations.

Visit www.jjay.cuny.edu/4808.php for more details on future relocation news and schedule.

MAJOR FEATURES

Great view of Clinton Park from the Conference Room

Anthropology & Math Research
Business Office
Conference Room
Grant Funded Programs
Human Resources
Psychology Research
Shared Conf. Room

Academic Advisement Center

646-557-4872, 4816

Academic Affairs

212-237-8802

Accessibility Services

212-237-8031

Advancement of Research

212-621-3735

Alumni Relations and Developments

212-237-8547

Audio Visual Services

212-237-8652

Barnes & Nobles College Bookstore

212-265-3619

Bursar's Office

212-237-8555

Counseling Services

212-237-8111

Enrollment Management

212-237-8118

Facilities Management

212-237-8541

Finance and Administration

212-237-8500

Gerald W. Lynch Theater

212-237-8005

Graduate Admissions

212-237-8863

Graduate Studies

212-237-8423

Health and Physical Education

212-237-8371

Health Office

212-237-8052

Human Resources

212-237-8517

646-557-HR4U(4748)

IT Helpdesk

212-237-8200

Jay Express Services

212-663-7867

jayexpress@jjay.cuny.edu

Marketing and Development

212-237-8628

President's Office

212-237-8600

Print Shop

212-237-8279

Public Safety

212-237-8524

For Emergencies Only

212-237-8888

Purchasing

212-237-8510

Student Affairs

212-237-8211

Testing Offices and Labs

212-237-8108

Undergraduate Admissions

212-JOHNJAY(564-6529)

admissions@jjay.cuny.edu

Undergraduate Studies

212-484-1347

Women's Center

212-237-8184

Writing Center

212-237-8569

Main

212-237-8000

www.jjay.cuny.edu